



## PUNTI DI CHIUSURA SUPPLEMENTARE



Punti di chiusura supplementare | Extra locking pin  
Pivot de fermeture supplementaire | Pernio de cierre suplementario



Perno e vite M5  
TSP CR in acciaio  
zincato. Art. 4246  
eccentrico di chiusura  
in zama, regolabile  
in pressione in 8  
posizioni diverse.



Pin and M5 TSP  
CR screw in  
galvanized steel.  
Art. 4246 locking  
cam in zamak, with  
adjustable pressure in  
8 different positions.



Pivot et vis M5 TSP  
CR en acier zingué.  
Art. 4246 came de  
fermeture en zamak,  
réglable en pression  
avec 8 positions  
différentes.



Pernio y tornillo M5  
TSP CR de acero  
galvanizado. Art. 4246  
excéntrica de cierre  
de zamak, regulable  
a presión en 8  
posiciones diferentes.



ART.	4241   4241.1   4242 4207.1   4207.2   4207.11   4246	4246.10   4246.11
Imballo   Package   Conditionnement   Embalaje	50 Pz	20 Pz
Finiture disponibili   Available finishes Finitions disponibles   Acabados disponibles	1 2 3 4	1 2 3 4

### 1 424X

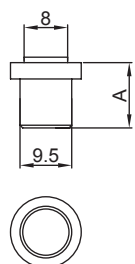

ART.	A
4241	9
4241.1	10.5
4242	12

### 2 4246

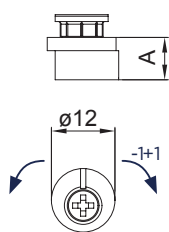

ART.	A
4246	8

### 3 4246.1

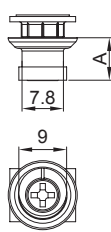

Abbinabile con la  
cremonese art. 6010.12  
Compatible with  
cremone-bolt art. 6010.12

ART.	A
4246	8

### 4 4248.1

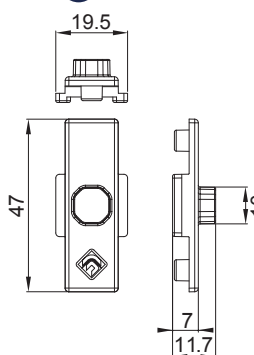

ART.	NODO SECTION
4248.11	A01 - A02 A03 A04 - A05 - A06 A07 - B01 - B03

### 5 4248.1X

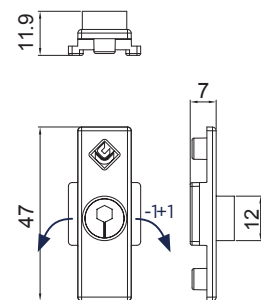

ART.	NODO SECTION
4248.11	A01 - A02 A03 A04 - A05 - A06 A07 - B01 - B03
4248.12	A08 - B04

### 6 4207.2

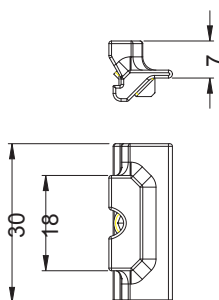

ART.	NODO SECTION
4207.2	A08 - B04

### 7 4207.1

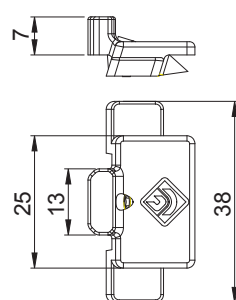

ART.	NODO SECTION
4207.1	A01 - A02 A03 A04 - A05 - A06 A07 - B01 - B03

### 8 4207.4

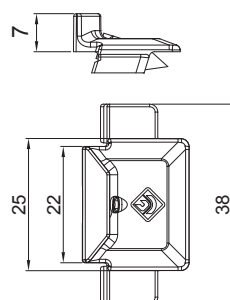

ART.	NODO SECTION
4207.4	A01 - A02 - A03 - A04 A05 - A06 - A07 - B01 B03

### 9 4207.11

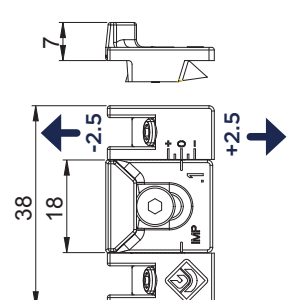

ART.	NODO SECTION
4207.11	A01 - A02 A03 - A04 A05 - A06 A07 - B01 B03

6 + 5

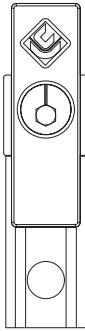

ART.	NODO SECTION
3421.32	A08 - B04

6 + 2



ART.	NODO SECTION
4246.10	A08 - B04

7 + 5

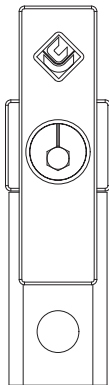
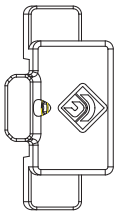

ART.	NODO SECTION
3520.32	A01 - A02 A03 - A04 A05 - A06 A07 - B01 B03

7 + 2

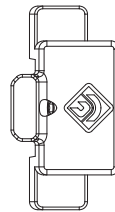

ART.	NODO SECTION
4246.11	A01 - A02 A03 - A04 A05 - A06 A07 - B01 B03

8 + 5

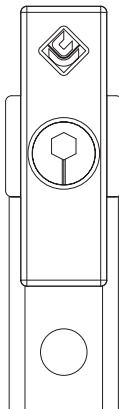
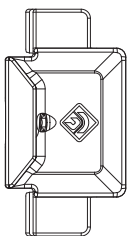

ART.	NODO SECTION
4207.21	A01 - A02 A03 - A04 A05 - A06 A07 - B01 B03

9 + 4

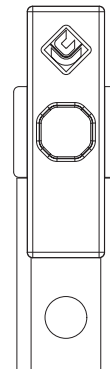
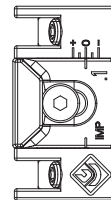

ART.	NODO SECTION
3400F.32	A01 - A02 A03 - A04 A05 - A06 A07 - B01 B03