

C500/H600

V cams with extension pieces

V18 / 25, SRH 1750 – 2800 mm (2-leafed)

① C500 – Faceplate 16/2						
B	D	⊕	HH	SF	Mat. no.	PQ
35	85	8	1013	SL	492001	5
40	85	8	1013	SL	490962	5
45	85	8	1013	SL	492002	5
50	85	8	1013	SL	492003	5
55	85	8	1013	SL	492004	5
55	92	8	1020	SL	611293	5
65	85	8	1013	SL	492095	5
70	85	8	1013	SL	492096	5
80	85	8	1013	SL	492097	5

① C500 – Faceplate 16/2 (E cam)						
B	D	⊕	HH	SF	Mat. no.	PQ
35	85	8	1013	SL	611189	5

① H600 – Faceplate 16/2						
B	D	⊕	HH	SF	Mat. no.	PQ
25	92	8	1020	SL	629196	5
28	92	8	1020	SL	629197	5
45	92	8	1020	SL	629899	5

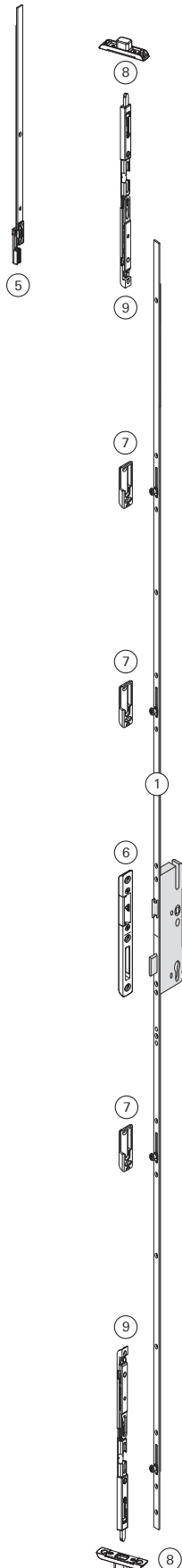

Timber strikers

Description SF Mat. no. PQ

4 clearance, 9 axis

⑥	Latch/deadbolt, left	SL	259287	50
	Latch/deadbolt, right	SL	259288	50
⑦	V cam, left	SL	289320	50
	V cam, right	SL	289321	50
⑧	Bolt with casing	SL	378963	50
	Bolt without casing	SL	378967	50

12 clearance, 9 axis

⑥	Latch/deadbolt, left	SL	256031	50
	Latch/deadbolt, right	SL	256032	50
⑦	V cam, left	SL	260382	50
	V cam, right	SL	260383	50
⑧	Bolt with casing	SL	378974	50
	Bolt without casing	SL	378978	50

* On left handed doors: use right handed V cam striker and vice versa!

Shootbolt protrusion, timber

Description SF Mat. no. PQ

⑨	305/9x18/4x9, with lever	SL	492136	10
---	--------------------------	----	---------------	----

(Note: Packer for 12 mm clearance enclosed!)

For strikers, refer to "frame components"

