

## 201838 - Cremonese A-B Multi Matic 2200 E15 fix con 3 funghi HBB 1.951-2.200 HM1.050 argento

### Disegni tecnici

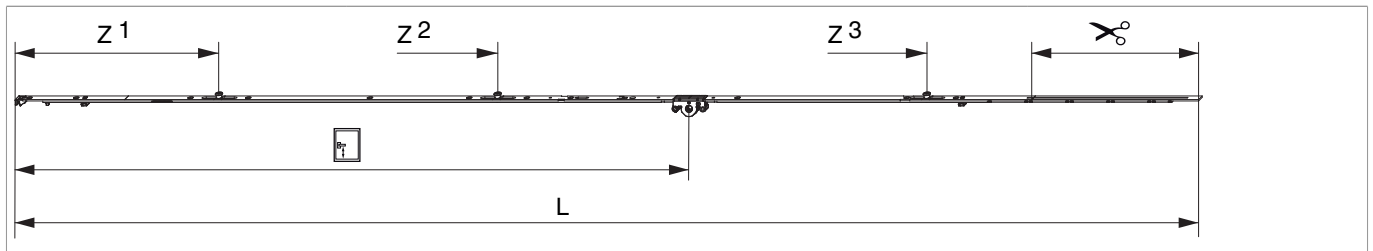

						<b>L</b>		<b>Nº</b>
argento	2200	15	1.050	1.951 - 2.200	260,5	2.096,5	10	201838

### Tabella posizionamento viti

<b>Nº</b>		1	2	3	4	5	6	7	8	9	10	11	12	13	14
201838	12	18,5	91,5	270	360	550	705	795	863,5	1.124	1.388	1.465	1.729		

### Tabella punti di chiusura

<b>Nº</b>		Z1	Z2	Z3	Z4
201838	3	315	750	1.420	

### Quote della scatola cremonese

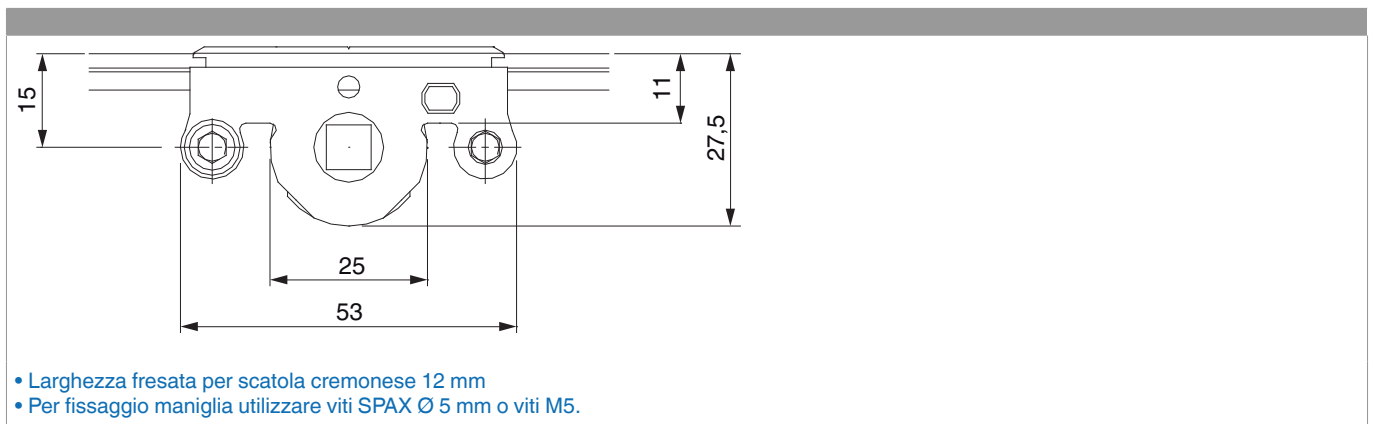

## Schema di foratura

Per serramenti in legno

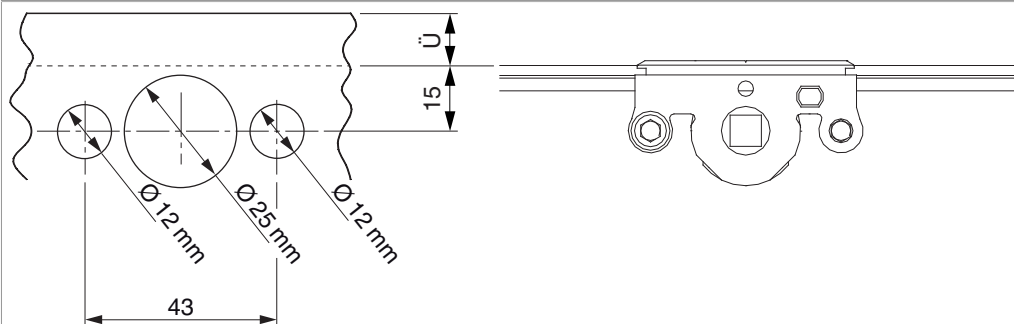

Per serramenti in PVC e alluminio

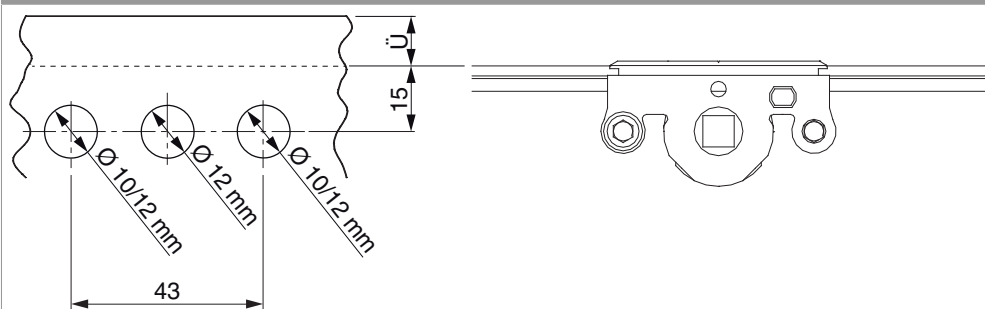

## Schema di tranciatura

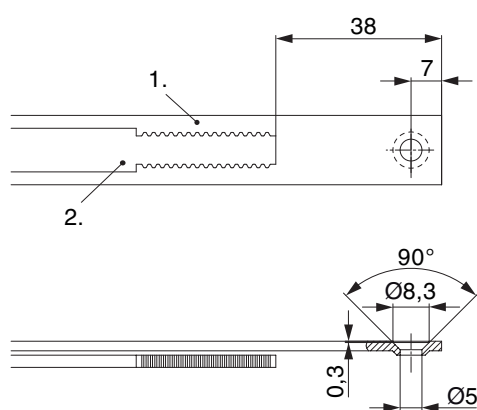

• Consigliamo di trattare il taglio dei componenti TRICOAT-PLUS con la vernice di ritocco TRICOAT-PLUS (cod. 358440).

1. Frontale
2. Asta mobile

## Collegamento a clips

Agganciare collegamenta a clips

①

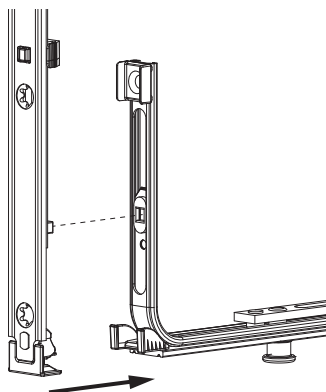

②

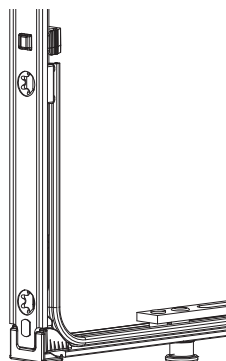

Sganciare collegamento clips

①

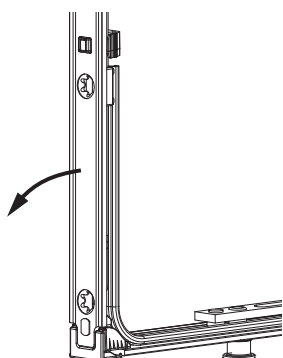

②

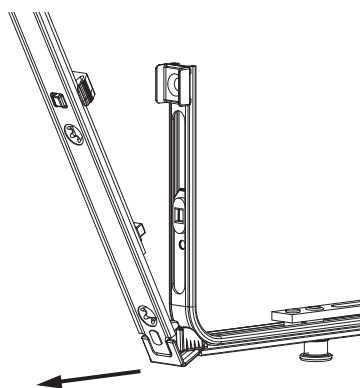

③

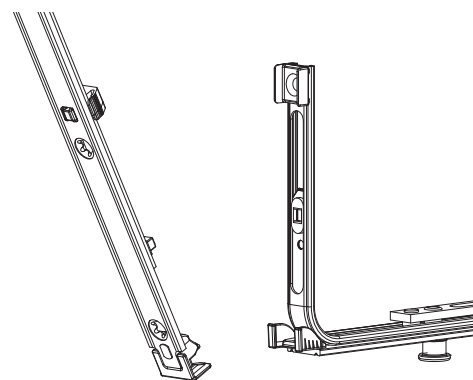

## Collegamento scarpetta dentata

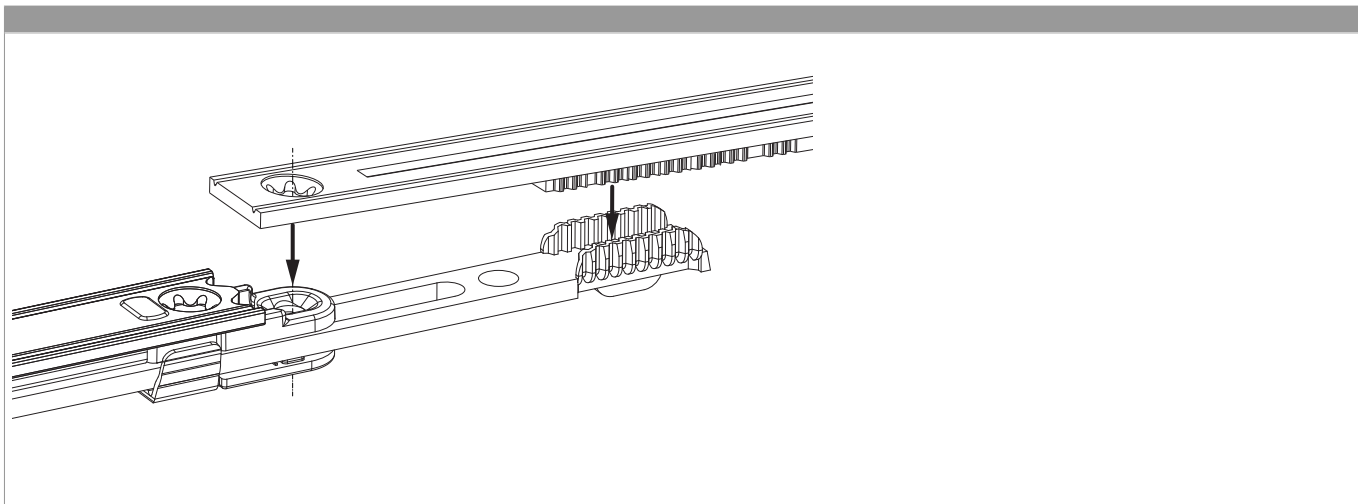

## Regolazione pressione

Fungo e nottolino

